

# IMPEDANCE MATCHING PADS

BNC (50 Ω) / BNC (75 Ω) DC - 1 GHz, 5.7 dB

## SPECIFICATIONS:

Models: 9033-50/75 & 9033-75/50

**RoHS**  
Compliant

**AEROFLEX**  
A passion for performance.

### Electrical:

Frequency Range \_\_\_\_\_ DC - 1 GHz  
Attenuation \_\_\_\_\_ 5.7 ±0.5 dB  
VSWR \_\_\_\_\_ 1.20:1 Max.  
Input Power \_\_\_\_\_ 1 Watt Avg @ +25°C  
Derated Linearly to 0.25 Watts @ +85°C  
Peak Power \_\_\_\_\_ 250 Watts Max.  
(5uSec Pulse, .05% Duty Cycle)  
Operating Temperature Range \_\_\_\_\_ -20°C to +85°C

### Mechanical:

BNC Connectors \_\_\_\_\_ Nickel Plated Brass  
Center Contacts \_\_\_\_\_ Gold Plated Beryllium Copper or Brass

Model Number: **9033-50/75**  
BNC Male 75 Ohm / BNC Female 50 Ohm

Model Number: **9033-75/50**  
BNC Male 50 Ohm / BNC Female 75 Ohm

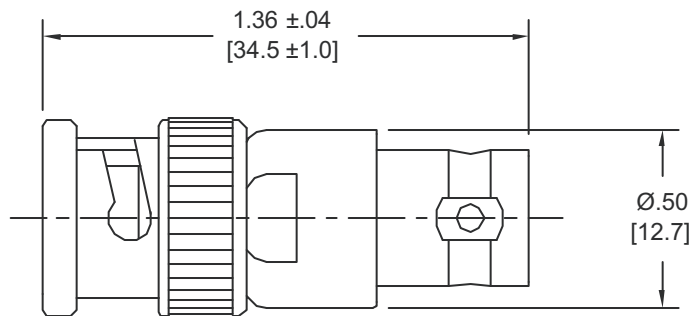

Note: Dimensions in Brackets are Expressed in Millimeters and are for Reference Only.

9033-50\_75: REV F

**AEROFLEX**  
INMET

Aeroflex / Inmet, Inc. • 300 Dino Drive, Ann Arbor, MI 48103 • U.S.A.  
888-244-6638 or 734-426-5553 • FAX: 734-426-5557  
www.aeroflex.com/inmet • inmet@aeroflex.com